



Score	Energy rating	Current	Potential
92+	A		
81-91	B		83 B
69-80	C		
55-68	D	58 D	
39-54	E		
21-38	F		
1-20	G		

Green Lane, Edgware

5 Bed Semi-Detached

Council tax band: G Tenure: Freehold

£889,000 STC
FOR SALE



297 Hale Lane
Edgware
Middlesex
HA8 7AX

t: 020 8958 8958
f: 020 8958 2300
e: info@groveresidential.co.uk
w: www.groveresidential.co.uk

Company No: 9632012

VAT Reg. No: 217 0421 50

Registered Address: 297 Hale Lane, Edgware, Middlesex, HA8 7AX



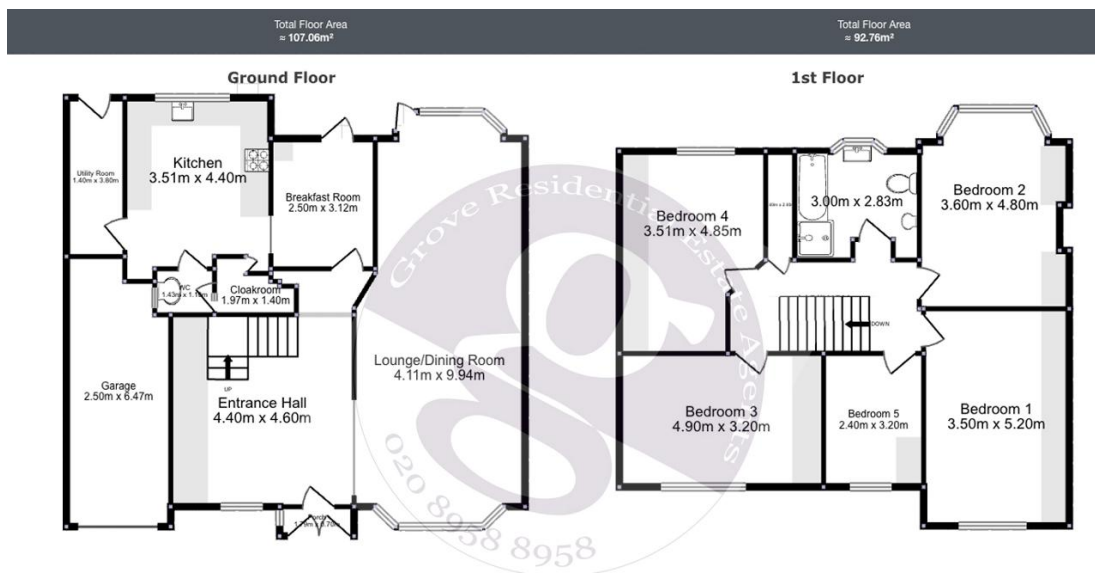

This floorplan has been prepared with all due care and attention, by Grove Residential for the convenience of intending buyers/tenants. Its accuracy is not guaranteed and it does not form any part of a contract. Purchasers/tenants should check by inspection its accuracy prior to signing a contract.

Key Features

- 5 Bedroom Semi Detached Family Home
- Scope For Extensions STPP
- Spacious Entrance Hallway
- Integral Garage
- 5 Bedrooms on 1st floor
- Private Rear Garden with Side Access

Summary

A substantial Curton built 5 bedroom semi detached family home situated on the sought after Green Lane. The property boasts generous living accommodation throughout as well as 5 good sized bedrooms on the first floor. In need of refurbishment throughout - this is an opportunity to design your own family home to your specification! Wa

Score	Energy rating	Current	Potential
92+	A		
81-91	B		83 B
69-80	C		
55-68	D	58 D	
39-54	E		
21-38	F		
1-20	G		

