



Energy Efficiency Rating			
Score	Energy rating	Current	Potential
92+	A		
81-91	B		
69-80	C		78 C
55-68	D		
39-54	E	52 E	
21-38	F		
1-20	G		

Morley Crescent, Edgware

3 Bed Semi-Detached

Council tax band: D Tenure: Assured Shorthold Tenancy

£2,100 per month
TO RENT



297 Hale Lane
Edgware
Middlesex
HA8 7AX

t: 020 8958 8958
f: 020 8958 2300
e: info@groveresidential.co.uk
w: www.groveresidential.co.uk

Company No: 9632012 VAT Reg. No: 217 0421 50
Registered Address: 297 Hale Lane, Edgware, Middlesex, HA8 7AX



GROUND FLOOR 53.11 sq. m.
(571.62 sq. ft.)

1ST FLOOR 50.44 sq. m.
(542.93 sq. ft.)

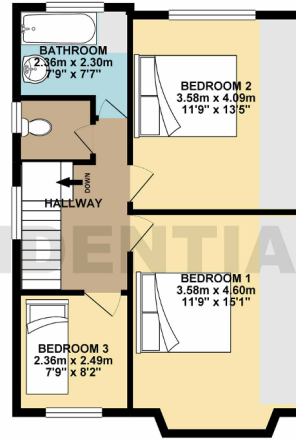
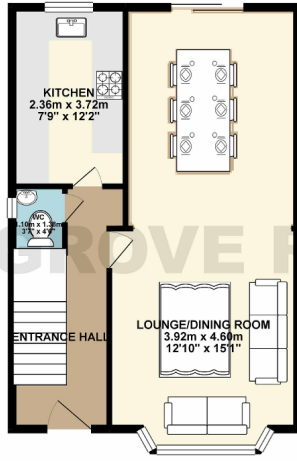

TOTAL FLOOR AREA: 103.55 sq. m. (1114.55 sq. ft.) approx.
While every effort has been made to ensure the accuracy of the floorplan, construction, measurement of doors, windows, rooms and any other items are approximate and no responsibility is taken for any error, omission or misstatement. This plan is for guidance purposes only and should be used as such for any prospective purchaser. The services, systems and appliances shown have not been tested and no guarantee as to their operability or efficiency can be given.
Issue with floor plan 02/20

Key Features

- 3 Bedroom Semi Detached Home
- Bathroom with Separate WC & Guest WC
- Double Reception Room
- Garage & Private Garden
- Double Glazing
- Available from End of March 2023

Summary

Set in this ever sought after residential cul-de-sac, a delightful three bedroom semi detached family home. Morley Crescent is a cul-de-sac off Kenilworth Road and a few hundred yards from the local shopping facilities of Glengall Parade, with easy access to Edgware Town Centre. Perfect for a family home. View now via sole agents Gro

Energy Efficiency Rating			
Score	Energy rating	Current	Potential
92+	A		
81-91	B		
69-80	C		78 C
55-68	D		
39-54	E	52 E	
21-38	F		
1-20	G		



The particulars have been prepared with all due care and attention, for the convenience of intending purchasers/tenants. Their accuracy is not guaranteed and they do not form any part of a contract. Purchasers/tenants should check by inspection the accuracy of the particulars prior to signing a contract.



297 Hale Lane t: 020 8958 8958
Edgware f: 020 8958 2300
Middlesex e: info@groveresidential.co.uk
HA8 7AX w: www.groveresidential.co.uk

Company No: 9632012 VAT Reg. No: 217 0421 50
Registered Address: 297 Hale Lane, Edgware, Middlesex, HA8 7AX

