



Energy Efficiency Rating			
Score	Energy rating	Current	Potential
92+	A		
81-91	B		86 B
69-80	C		
55-68	D	64 D	
39-54	E		
21-38	F		
1-20	G		

## Fairview Way, Edgware

3 Bed Semi-Detached

Council tax band: F Tenure: Assured Shorthold Tenancy

**£2,400** per month  
**TO RENT**



297 Hale Lane  
Edgware  
Middlesex  
HA8 7AX

t: 020 8958 8958  
f: 020 8958 2300  
e: [info@groveresidential.co.uk](mailto:info@groveresidential.co.uk)  
w: [www.groveresidential.co.uk](http://www.groveresidential.co.uk)

Company No: 9632012

VAT Reg. No: 217 0421 50

Registered Address: 297 Hale Lane, Edgware, Middlesex, HA8 7AX



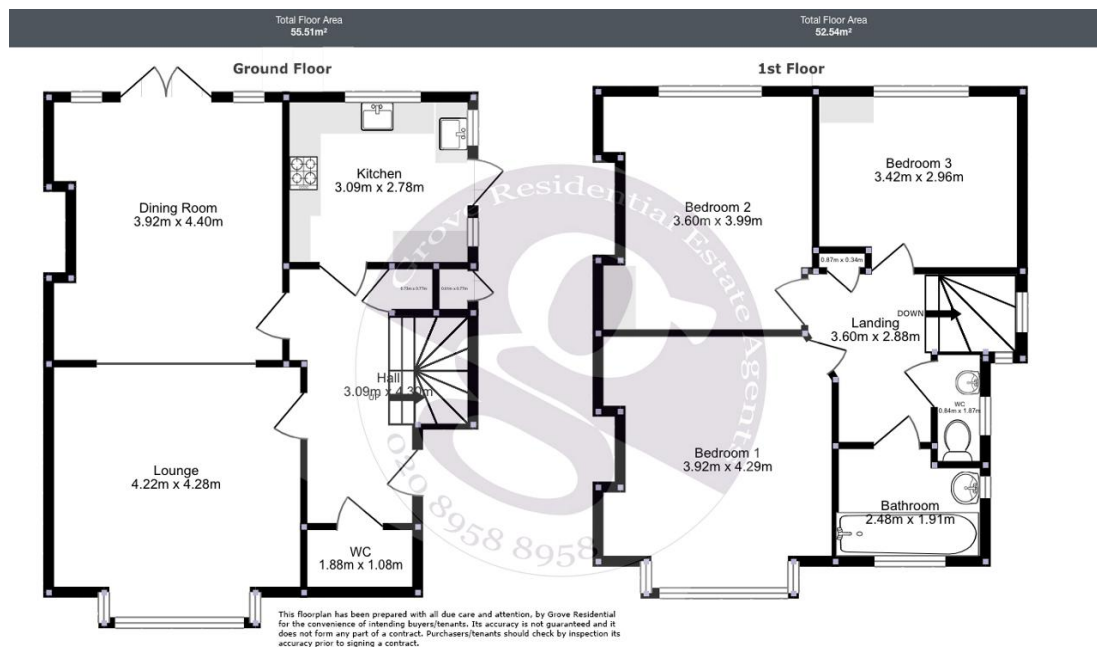

## Key Features

- 3 Bedroom Semi Detached Home
- Brand New Kosher Kitchen
- Living/Dining Room
- Modern Family Bathroom & Guest WC
- Double Reception Room
- Front & Rear Garden with Side Access

## Summary

A beautifully appointed 3 bedroom semi detached home located on the desirable Fairview Way within the Eruv. The property benefits from a new kosher kitchen with two separate sinks, painted & decorated throughout as well as new internal doors. Gas Central Heating & Double Glazing. To avoid missing out on this superb rental, call

Energy Efficiency Rating			
Score	Energy rating	Current	Potential
92+	A		
81-91	B		86   B
69-80	C		
55-68	D	64   D	
39-54	E		
21-38	F		
1-20	G		

