



Energy Efficiency Rating			
Score	Energy rating	Current	Potential
92+	A		
81-91	B		
69-80	C	72 C	77 C
55-68	D		
39-54	E		
21-38	F		
1-20	G		

Symphony Close, Edgware

2 Bed Flat

Council tax band: E Tenure: Assured Shorthold Tenancy

£1,650 per month
TO RENT



297 Hale Lane
Edgware
Middlesex
HA8 7AX

t: 020 8958 8958
f: 020 8958 2300
e: info@groveresidential.co.uk
w: www.groveresidential.co.uk

Company No: 9632012

VAT Reg. No: 217 0421 50

Registered Address: 297 Hale Lane, Edgware, Middlesex, HA8 7AX



PROTECTED



PROTECTED

GROUND FLOOR
637 sq.ft. (59.1 sq.m.) approx.

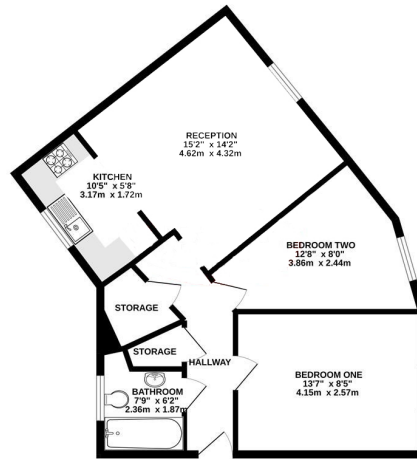

TOTAL FLOOR AREA: 637 sq.ft. (59.1 sq.m.) approx.
When every attempt has been made to ensure the accuracy of the floorplan provided here, measurements of walls, windows, doors and other features are approximate and do not constitute a contract. The accuracy of the floorplan is not guaranteed. The floorplan is provided for information only and should not be used as a basis for any legal proceedings. The floorplan is provided for information only and should not be used as a basis for any legal proceedings. The floorplan is provided for information only and should not be used as a basis for any legal proceedings.

Key Features

- 2 Bedroom Ground Floor Flat
- Brand New Kitchen
- Redecorated Throughout
- Modern Family Bathroom
- Double Glazing + Gas Central Heating
- Available Now !

Summary

A stunning 2 bedroom ground floor flat available now to rent, on the popular Symphony Close development. The property boasts a brand new kitchen, new flooring & is redecorated throughout. Close proximity to all amenities and transport links. View now via Grove Residential on 0208 958 8958 !

Energy Efficiency Rating			
Score	Energy rating	Current	Potential
92+	A		
81-91	B		
69-80	C	72 C	77 C
55-68	D		
39-54	E		
21-38	F		
1-20	G		

Energy Efficiency Rating

Score	Energy rating	Current	Potential
92+	A		
81-91	B		
69-80	C	72 C	77 C
55-68	D		
39-54	E		
21-38	F		
1-20	G		

The particulars have been prepared with all due care and attention, for the convenience of intending purchasers/tenants. Their accuracy is not guaranteed and they do not form any part of a contract. Purchasers/tenants should check by inspection the accuracy of the particulars prior to signing a contract.