



Energy Efficiency Rating			
Score	Energy rating	Current	Potential
92+	A		
81-91	B		
69-80	C	72 C	77 C
55-68	D		
39-54	E		
21-38	F		
1-20	G		

Symphony Close, Edgware

2 Bed Flat

Council tax band: E Tenure: Leasehold

£299,950 STC
FOR SALE



297 Hale Lane
Edgware
Middlesex
HA8 7AX

t: 020 8958 8958
f: 020 8958 2300
e: info@groveresidential.co.uk
w: www.groveresidential.co.uk

Company No: 9632012

VAT Reg. No: 217 0421 50

Registered Address: 297 Hale Lane, Edgware, Middlesex, HA8 7AX



GROUND FLOOR

637 sq.ft. (59.1 sq.m.) approx.

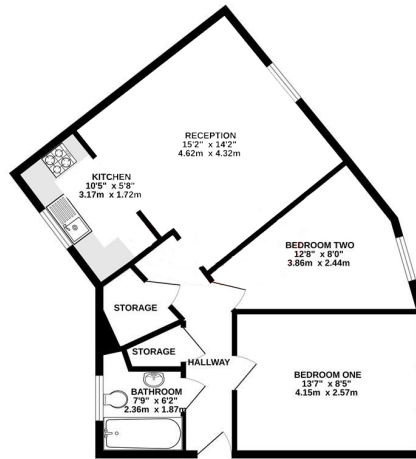

TOTAL FLOOR AREA: 637 sq.ft. (59.1 sq.m.) approx.
While every attempt has been made to ensure the accuracy of the floorplan, the floorplan is not a guarantee of the actual floor area. The floorplan is a guide only and should not be used as a basis for any financial or legal transaction. The floorplan is not a guarantee of the actual floor area. The floorplan is a guide only and should not be used as a basis for any financial or legal transaction.

Key Features

- 2 Bedroom Ground Floor Flat
- Lounge/Dining Room - New Flooring
- New Kitchen
- Bathroom
- Allocated parking space
- Leasehold

Summary

A 2 bedroom ground floor flat located in the Symphony Close development. The property has recently been redecorated and benefits from an allocated parking space, gas central heating and double glazing. Ideal for investors or first time purchasers. The property is offered to the market chain free. View Now via Grove Residential

Energy Efficiency Rating			
Score	Energy rating	Current	Potential
92+	A		
81-91	B		
69-80	C	72 C	77 C
55-68	D		
39-54	E		
21-38	F		
1-20	G		

The particulars have been prepared with all due care and attention, for the convenience of intending purchasers/tenants. Their accuracy is not guaranteed and they do not form any part of a contract. Purchasers/tenants should check by inspection the accuracy of the particulars prior to signing a contract.



297 Hale Lane
 Edgware
 Middlesex
 HA8 7AX
 t: 020 8958 8958
 f: 020 8958 2300
 e: info@groveresidential.co.uk
 w: www.groveresidential.co.uk

Company No: 9632012 VAT Reg. No: 217 0421 50
 Registered Address: 297 Hale Lane, Edgware, Middlesex, HA8 7AX

