



Energy Efficiency Rating			
Score	Energy rating	Current	Potential
92+	A		
81-91	B		85 B
69-80	C		
55-68	D	62 D	
39-54	E		
21-38	F		
1-20	G		

Farm Road, Edgware

4 Bed Semi-Detached

Council tax band: E Tenure: Freehold

Offers in Region of **£785,000** STC
FOR SALE



297 Hale Lane
Edgware
Middlesex
HA8 7AX

t: 020 8958 8958
f: 020 8958 2300
e: info@groveresidential.co.uk
w: www.groveresidential.co.uk

Company No: 9632012

VAT Reg. No: 217 0421 50

Registered Address: 297 Hale Lane, Edgware, Middlesex, HA8 7AX



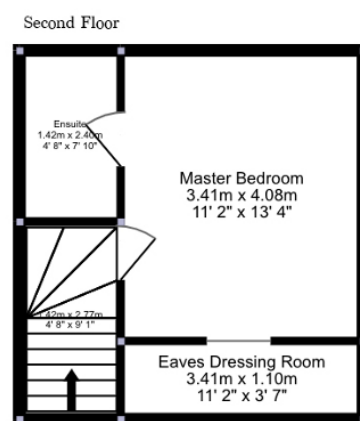
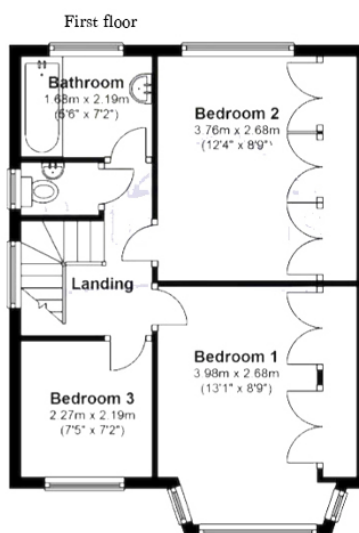
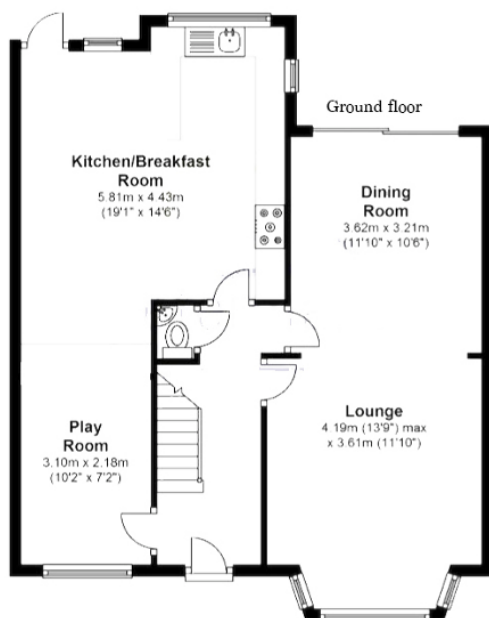

Key Features

- 4 Bedroom Semi-Detached House
- Ultra Modern Kosher Kitchen/Breakfast Rm
- Modern Ensuite, Bathrm and Guest WC
- Lounge/Dining Room
- Extended downstairs living area
- Study/TV Area

Summary

A gorgeous extended 4 bedroom 2 bathroom family home located at the beginning of Farm Road, within the Edgware Eruv and close to all amenities. This modern home has been lovingly extended to offer adaptive living space including a generously sized eat in kosher kitchen, and even had further planning permission passed in 2017 (subject

Energy Efficiency Rating			
Score	Energy rating	Current	Potential
92+	A		
81-91	B		85 B
69-80	C		
55-68	D	62 D	
39-54	E		
21-38	F		
1-20	G		

