



Energy Efficiency Rating			
Score	Energy rating	Current	Potential
92+	A		
81-91	B		
69-80	C	73   C	81   B
55-68	D		
39-54	E		
21-38	F		
1-20	G		

## Chatsworth Road, Mapesbury

1 Bed Apartment

Council tax band: C Tenure: Assured Shorthold Tenancy

**£1,725** per month  
**TO RENT**



297 Hale Lane  
Edgware  
Middlesex  
HA8 7AX

t: 020 8958 8958  
f: 020 8958 2300  
e: [info@groveresidential.co.uk](mailto:info@groveresidential.co.uk)  
w: [www.groveresidential.co.uk](http://www.groveresidential.co.uk)

Company No: 9632012

VAT Reg. No: 217 0421 50

Registered Address: 297 Hale Lane, Edgware, Middlesex, HA8 7AX



Total Floor Area  
52.03m<sup>2</sup>

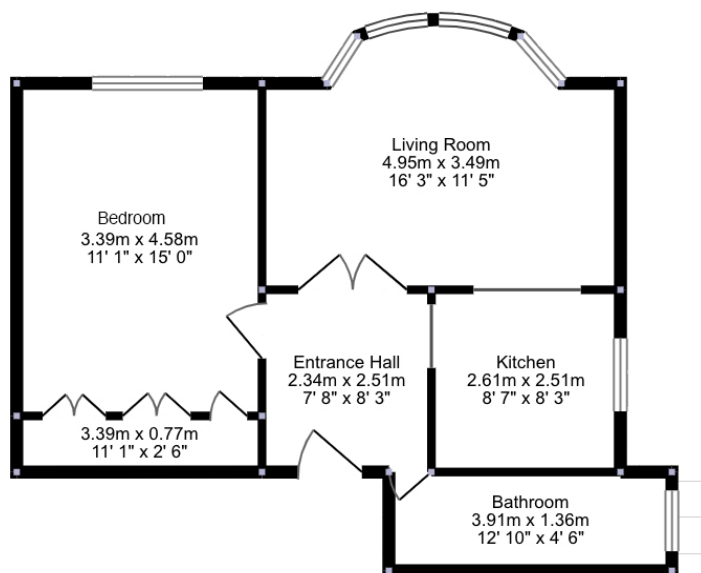

## Key Features

- Stunning 1 Bedroom 1st Floor Apartment
- Lounge/Dining Room
- Modern Kitchen
- Contemporary Bathroom
- Fitted cupboards
- Wood flooring

## Summary

A skilfully recently refurbished 1 Bedroom first-floor apartment located in this practical location within walking distance of Kilburn Underground station & in easy reach of all other amenities. The property boasts ample living spaces, wood flooring and high ceilings. View Now via sole agents Grove Residential to avoid disappointment

Energy Efficiency Rating			
Score	Energy rating	Current	Potential
92+	A		
81-91	B		
69-80	C	73   C	81   B
55-68	D		
39-54	E		
21-38	F		
1-20	G		



The particulars have been prepared with all due care and attention, for the convenience of intending purchasers/tenants. Their accuracy is not guaranteed and they do not form any part of a contract. Purchasers/tenants should check by inspection the accuracy of the particulars prior to signing a contract.



297 Hale Lane  
Edgware  
Middlesex  
HA8 7AX

t: 020 8958 8958  
f: 020 8958 2300  
e: [info@groveresidential.co.uk](mailto:info@groveresidential.co.uk)  
w: [www.groveresidential.co.uk](http://www.groveresidential.co.uk)

Company No: 9632012

VAT Reg. No: 217 0421 50

Registered Address: 297 Hale Lane, Edgware, Middlesex, HA8 7AX

