



## Leeland Way, Neasden

2 Bed Flat

Council tax band: TBC Tenure: Assured Shorthold Tenancy

**£1,495** per month  
**TO RENT**



297 Hale Lane  
Edgware  
Middlesex  
HA8 7AX

t: 020 8958 8958  
f: 020 8958 2300  
e: [info@groveresidential.co.uk](mailto:info@groveresidential.co.uk)  
w: [www.groveresidential.co.uk](http://www.groveresidential.co.uk)

Company No: 9632012

VAT Reg. No: 217 0421 50

Registered Address: 297 Hale Lane, Edgware, Middlesex, HA8 7AX



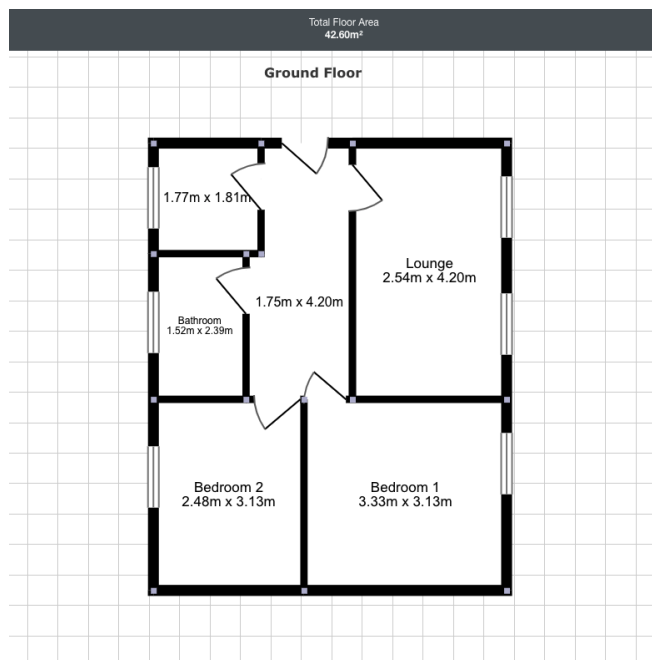

## Key Features

- 2 Double Bedrooms
- Lounge/Dining Room
- New kitchen
- New Bathroom
- Gas Central Heating
- New Carpets

## Summary

A refurbished two bedroom 2nd floor apartment set in this central location near amenities and transport facilities. The property has a generous lounge and two good size bedrooms plus the benefit of gas central heating and double glazing.

Call 0208 958 8958 to arrange a viewing !

Energy Efficiency Rating			
Score	Energy rating	Current	Potential
92+	A		
81-91	B		
69-80	C	70   C	80   C
55-68	D		
39-54	E		
21-38	F		
1-20	G		

The particulars have been prepared with all due care and attention, for the convenience of intending purchasers/tenants. Their accuracy is not guaranteed and they do not form any part of a contract. Purchasers/tenants should check by inspection the accuracy of the particulars prior to signing a contract.