

3 Bedroom Flat for Sale - Offers in Excess of £450,000

Edgwarebury Lane, Edgware, Middlesex, HA8 8LY



KEY FEATURES

- 3 BEDROOM 1ST FLOOR APARTMENT • ENSUITE • ULTRA MODERN LIVING • LOUNGE/DINING/KITCHEN • ULTRA MODERN KITCHEN • LOUNGE/DINING ROOM • PRIVATE GARDEN • JOINT SOLE AGENTS

Description

A first floor 3 Bedroom luxury apartment, set in this development of 3 apartments, located in central Edgware within walking distance of Edgware's shopping precinct and public transport. The block has been designed to benefit each flat with the maximum amount of light and space possible. With share of freehold and the benefit of no service charge and no ground rent charges plus energy efficient lighting and insulation the flat keeps costs at a minimum for its owner.

Hitech German kitchen with granite worktops, ensuite facility, alarm system, allocated parking, solid wood flooring, integrated appliances are just some of the luxury that has been tailored into this flat.

To arrange an internal viewing of the apartments please call our instructed agents.



Ground Floor

Property Description - A Top floor luxury apartment, set in this development of 3 apartments, located in central Edgware within walking distance of Edgware's shopping precinct and public transport. The block has been designed to benefit each flat with the maximum amount of light and space possible. With share of freehold and the benefit of no service charge and no ground rent charges plus energy efficient lighting and insulation the flat keeps costs at a minimum for its owner.

Hitech German kitchens with granite worktops, ensuite facility, alarm systems, allocated parking, solid wood flooring, integrated appliances are just some of the luxury that has been tailored into this development.

To arrange an internal viewing of the apartments please call our instructed agents.

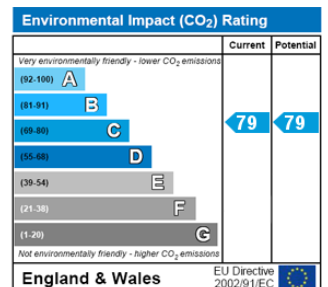
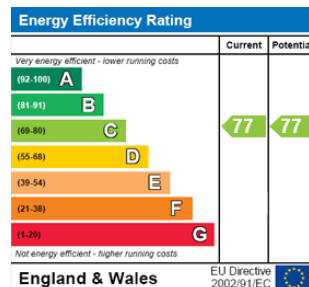

297 Hale Lane
Edgware
Middlesex
HA8 7AX
t: 020 8958 8958
f: 020 8958 2300
e: info@groveresidential.co.uk
w: www.groveresidential.co.uk

Company No: 9632012
Registered Address: 297 Hale Lane, Edgware, Middlesex, HA8 7AX
VAT Reg. No: 217 0421 50





The information contained within this website is for guidance purposes. The particulars have been prepared with all due care and attention, for the convenience of intending purchasers/tenants. Their accuracy is not guaranteed and they do not form any part of a contract. Purchasers/tenants should check by inspection the accuracy of the particulars prior to signing a contract.



297 Hale Lane t: 020 8958 8958
Edgware f: 020 8958 2300
Middlesex e: info@groveresidential.co.uk
HA8 7AX w: www.groveresidential.co.uk

Company No: 9632012 VAT Reg. No: 217 0421 50
Registered Address: 297 Hale Lane, Edgware, Middlesex, HA8 7AX



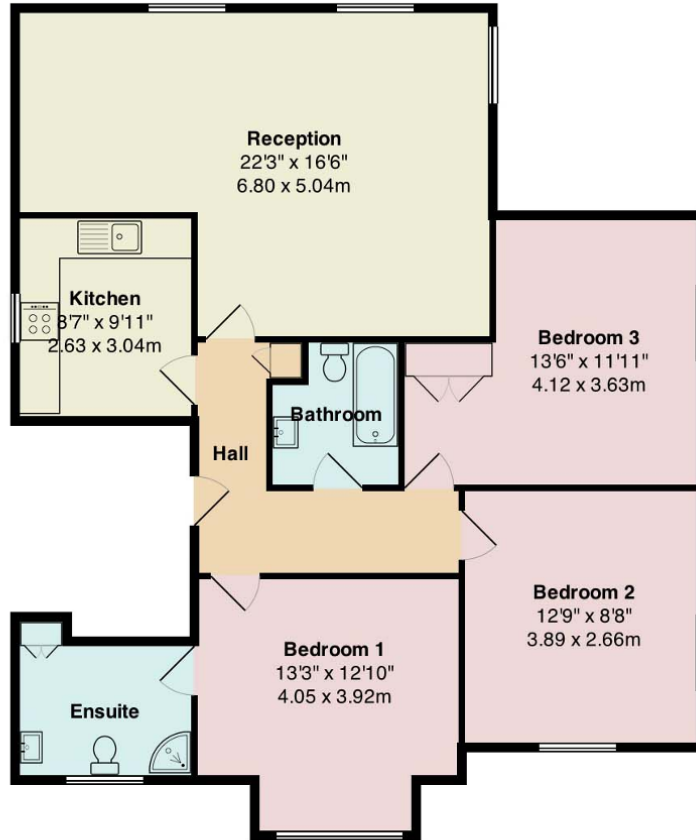

First Floor

Edwarebury Lane (2) HA8

Total Area: 1109 ft² ... 103.0 m²

All measurements are approximate and for display purposes only